

## TECHNICAL SPECIFICATION

7/16F-7/16F A

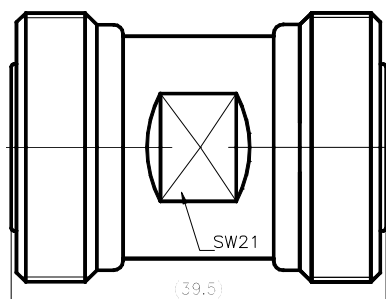

7/16 Type female to 7/16 Type female

ID:2.4.81.2222.1

Rev: A0

### Material and Plating

Center contact

Tin Bronze / Silver Plated

Outer contact & Body

Brass / Trimetal Plated

Dielectric

PTFE

### Electrical Specifications

Characteristics Impedance

50 Ohm

Frequency Range

DC~7.5GHz

Insulation Resistance

$\geq 10000\text{M}\Omega$

Dielectric Withstanding Voltage

4000V rms

Operating Voltage

2500V rms

Center contact resistance

$\leq 0.40\text{m}\Omega$

Outer contact resistance

$\leq 0.20\text{m}\Omega$

Insertion Loss

@DC-3.0 GHz

$\leq 0.17\text{dB}$

VSWR

@0.8-1.0 GHz

$\leq 1.08$

@1.0-3.0 GHz

$\leq 1.10$

PIM3

$\leq -155\text{dBc}$

### Environmental & Mechanical Specifications

Durability (matings)

$\geq 500$  cycles

Mechanical Shock Test Method

MIL-STD-202, Method 213, Test Condition D

Vibration Test Method

MIL-STD-202, Meth. 204, Cond. A

Temperature Range

$-65^{\circ}\text{C}$  to  $+165^{\circ}\text{C}$

RoHS

Compliant

### Regulatory Compliance / Certification

ISO 9001:2015

Compliant

*The facts and figures contained herein are carefully complied to the best of our knowledge, but they are intended for general informational purposes only.*