

## 1. Figure

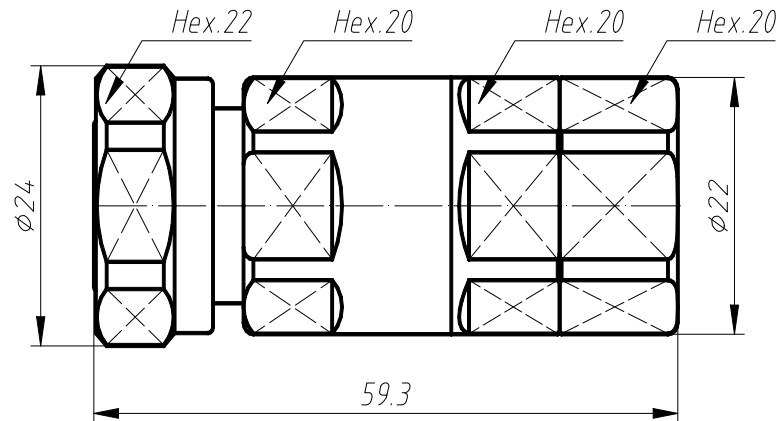

## 2. Product Description

4310M-1/2"L

4.3-10 Straight male Connector for 1/2" Flexible RF Cable

## 3. Material and Plating

Inner Conductor Pin	Brass / Silver Plating
Inner Conductor Socket	Tin Bronze / Silver Plating
Insulator	PTFE/TPX
Body & Outer Conductor	Brass / Trimetal Plating
Gasket	Silicon Rubber
Nut	Brass / Trimetal Plating

## 4. Electrical Characteristics

Characteristics Impedance	50 Ohm
Frequency Range	DC~6GHz
Insulation Resistance	≥5000MΩ
Dielectric Withstanding Voltage	2500V rms
Operating Voltage	1400V rms
Center contact resistance	≤1.5 mΩ
Outer contact resistance	≤1.5 mΩ
Insertion Loss @DC-2.7 GHz	≤0.10dB
VSWR @0.8-1.0 GHz	≤1.08
@1.7-2.7 GHz	≤1.10
PIM3 (2*20W)	≤-160dBc

## 5. Environmental and Mechanical Specifications

Durability (matings)	≥500 cycles
Mechanical Shock Test Method	MIL-STD-202, Method 213, Test Condition D
Vibration Test Method	MIL-STD-202, Meth. 204, Cond. A
Temperature Range	-45°C to +85°C
RoHS	Compliant
Sealing Class	IP68 24hr, 1m, 20°C

The facts and figures contained herein are carefully compiled to the best of our knowledge, but they are intended for general informational purposes only.

Orbis product code: 3004808

[www.orbis.fi](http://www.orbis.fi)

[www.orbis.eu](http://www.orbis.eu)

[www.orbis.com.ru](http://www.orbis.com.ru)