

TECHNICAL SPECIFICATION

7/16F-1-1/4”L

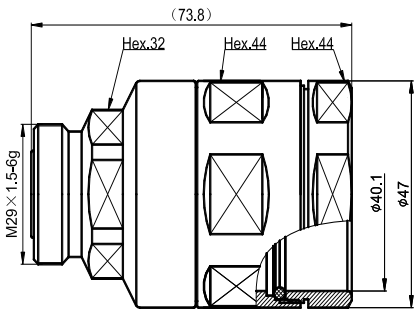

7/16 Straight female Connector for
1-1/4 Flexible RF Cable

ID: 2.4.21.22.03

Rev: A0

Material and Plating

Inner Conductor Pin	Brass / Silver Plating
Inner Conductor Socket	Tin Bronze / Silver Plating
Insulator	PTFE/TPX
Body & Outer Conductor	Brass / Trimetal Plating
Gasket	Silicon Rubber

Electrical Specifications

Characteristics Impedance	50 Ohm
Frequency Range	DC~2.7GHz
Insulation Resistance	≥10000MΩ
Dielectric Withstanding Voltage	4000V rms
Operating Voltage	2700V rms
Center contact resistance	≤0.4 mΩ
Outer contact resistance	≤0.2 mΩ
Insertion Loss	@DC-2.7 GHz ≤0.10dB
VSWR	@0.8-1.0 GHz ≤1.10
	@1.7-2.7 GHz ≤1.13
PIM3(2*43dBm)	≤-155dBc

Environmental & Mechanical Specifications

Durability (matings)	≥500 cycles
Mechanical Shock Test Method	MIL-STD-202, Method 213, Test Condition D
Vibration Test Method	MIL-STD-202, Meth. 204, Cond. A
Temperature Range	-65°C to +85°C
RoHS	Compliant
Sealing Class	IP68 24hr, 1m, 20°C

Regulatory Compliance / Certification

ISO 9001:2015	Compliant
---------------	-----------

The facts and figures contained herein are carefully complied to the best of our knowledge, but they are intended for general informational purposes only.